

SPRING DRIVEN WELDING CABLE REELS **P-WC SERIES**

COXREELS® P-WC Series spring driven “Welding Cable” reels protect and extend the life of your welding cable by neatly and conveniently storing it on a 8, 11 or 15 meter self-retracting welding cable reel. They are the solution for keeping your work area safe, organized and efficient.

WELDING CABLE REEL

Protect & extend the life of your welding cable while keeping your work area and vehicles clean & organized. **Caution: When using reel for extended periods of time unwind all cable to prevent heat build up.**

CABLE							LESS CABLE		SIZE INDEX
MODEL	LENGTH m	AWG	Ø (mm²)	VOLTS	AMPS.	Kg.	MODEL	Kg.	
P-WC13-3506	11	6 GA	13.3	600	75	14	P-WC13L-3506	12	1
P-WC13-5006	15	6 GA	13.3	600	75	16	P-WC13L-5006	13	1
P-WC13-3504	11	4 GA	21.1	600	150	15	P-WC13L-3504	12	1
P-WC13-5004	15	4 GA	21.1	600	150	18	P-WC13L-5004	13	1
P-WC13-3502	11	2 GA	33.6	600	225	16	P-WC13L-3502	12	1
P-WC17-5002	15	2 GA	33.6	600	225	25	P-WC17L-5002	19	2
P-WC13-2501	8	1 GA	42.4	600	300	16	P-WC13L-2501	12	1
P-WC17-5001	15	1 GA	42.4	600	300	27	P-WC17L-5001	19	2
P-WC13-2510	8	1/0	53.5	600	350	17	P-WC13L-2510	12	1
P-WC17-5010	15	1/0	53.5	600	350	29	P-WC17L-5010	19	2
P-WC17-3520	11	2/0	67.4	600	450	27	P-WC17L-3520	19	2
P-WC17-5020	15	2/0	67.4	600	450	31	P-WC17L-5020	19	2

REEL DIMENSIONS Technical Data Sheets Available On Website

SIZE INDEX	W mm	H mm	L mm	X mm	Y mm	M mm	N mm
1	216	368	349	127	152	76	127
2	279	464	438	152	152	102	127

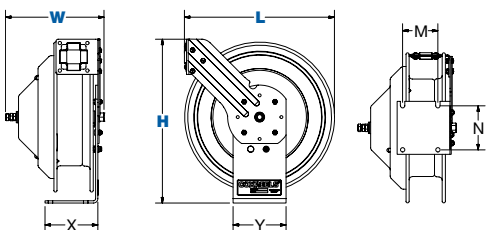

COXREELS® ACCESSORY

	<p>Electrode Holder Electrode holder features a six-position jaw pattern and has fully insulated, protected springs. # 7685</p>		<p>Grounding Clamp 300 Amp with solid copper jaws & fits cable ballpoint thru 3/0. #7688</p>
---	--	---	---



P-WC SERIES :: REEL SPECIFICATIONS

SLIP RING

- External, easily accessible heavy gauge CPC™ powder coated steel components cover for simple slip ring routine maintenance
- Electrical current runs through a 450 AMP rated slip ring

DESIGN & STRUCTURE

- Designed for electrode & grounding lead applications (each lead requires an individual reel)
- Single pedestal reel with space saving design facilitates workplace organization
- Welding cable clamp available (see below)
- Guide arm adjusts to wall, floor, vehicle & overhead positions
- Solid one piece, heavy gauge 6 mm steel base & support post for maximum stability
- 25 mm solid steel axle & lubricated precision bearings for smooth rotation

RETRACTION

- Enclosed factory tuned & matched cartridge-style spring motor
- Non corrosive stainless steel spring, pawl & zinc plated ratchet
- Multi-position lock ratchet mechanism secures cable at desired length

SIGNATURE FEATURES

- Professional grade heavy duty steel construction
- Durable proprietary CPC™ powder coat process
- Rolled edges & ribbed discs provide strength & safety
- Leading 2-year manufacturer's limited warranty
- Made in the U.S.A. - Sold & Supported Worldwide

POSSIBLE FIELDS OF APPLICATION

- Manufacturing Plants & Facilities
- Maintenance, Repair & Operations
- Welding / Service Trucks
- Welding Shops
- Garage Settings
- Automotive & Fleet Maintenance
- Pipelines
- Mining, Construction & Railroad Operations
- Marine/Ship Building/ Offshore

ACCESSORIZE YOUR REEL :: PG 50

- Mounting Brackets
- Assorted Reel Accessories

